

Floating Frame

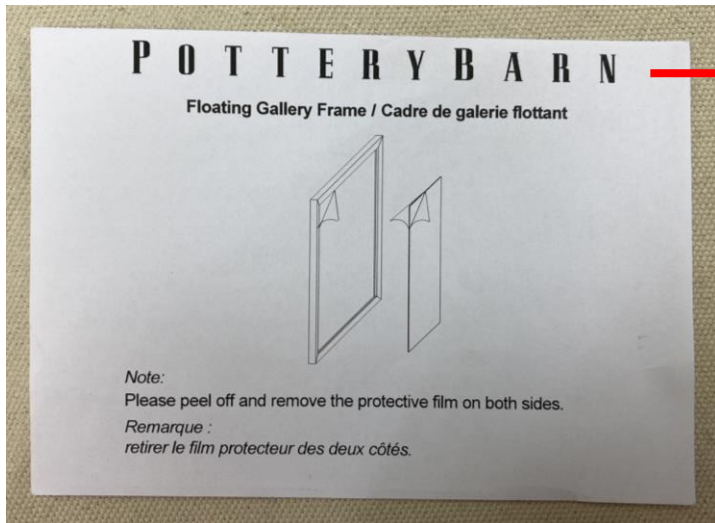

Front Side



Back Side

How to insert the image in Floating Frame

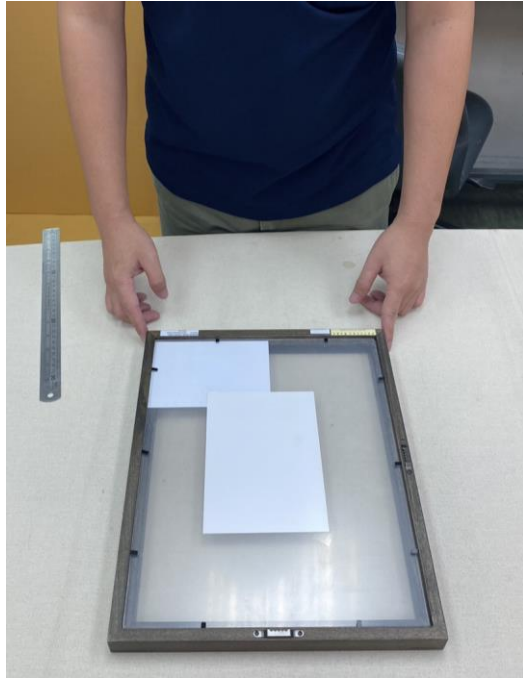

1. Turn over the back side and using the ruler, lift up all the flexi tabs.

How to insert the image in Floating Frame

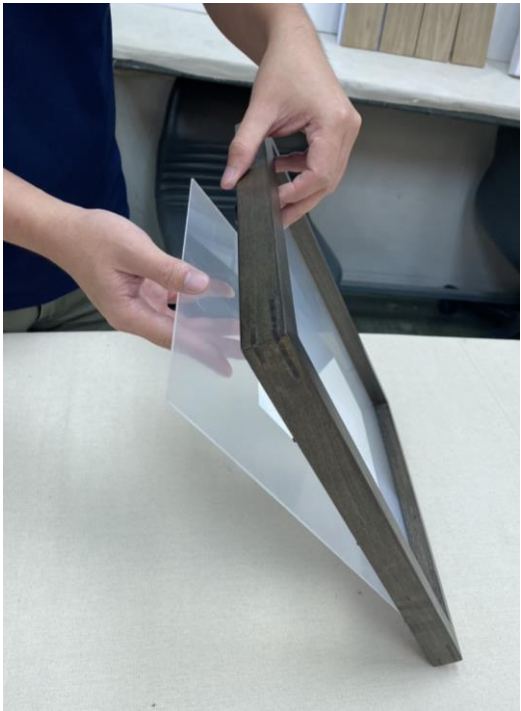

2. After lifting up all the flexi tabs, let the acrylic (back side) out of the frame

How to insert the image in Floating Frame

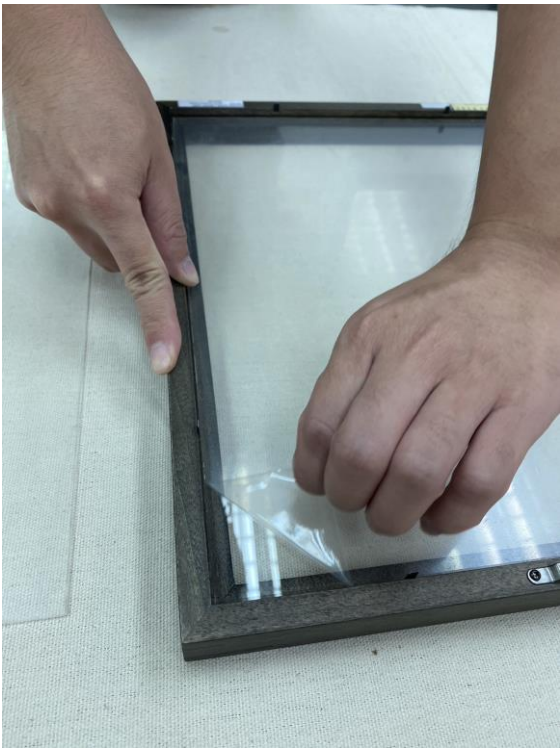
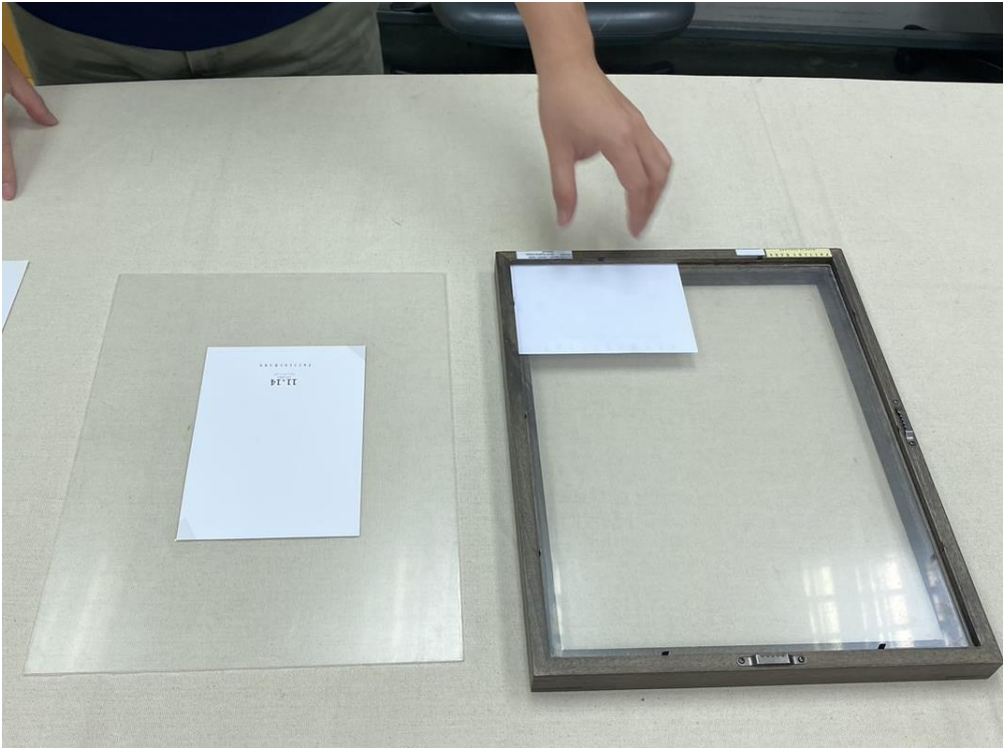

3. Peel off and remove the protection film on the frame side

How to insert the image in Floating Frame

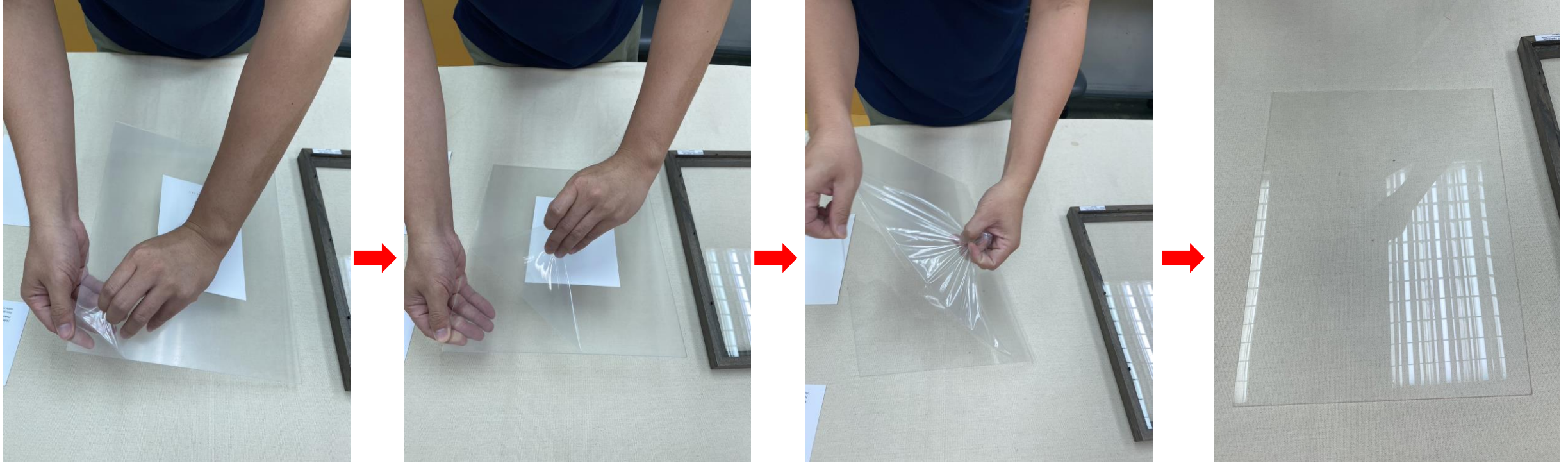

4. Peel off and remove the protection film on both sides of acrylic (back side) .

How to insert the image in Floating Frame

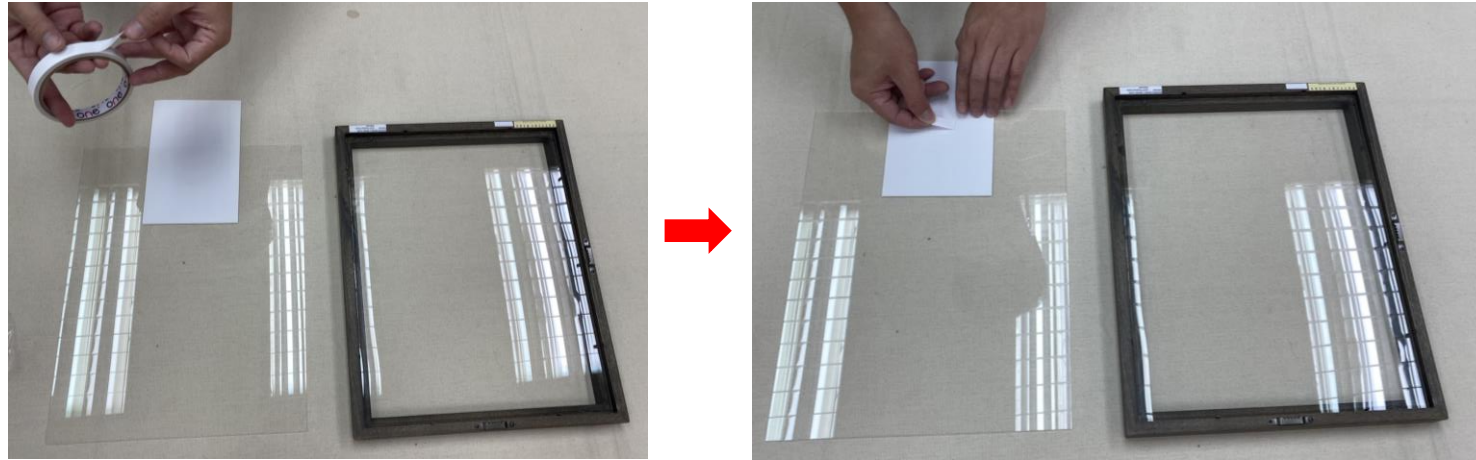

4. Use the double-sided tape on the back of the picture. And peel off the protection file. Then put the acrylic on the frame.

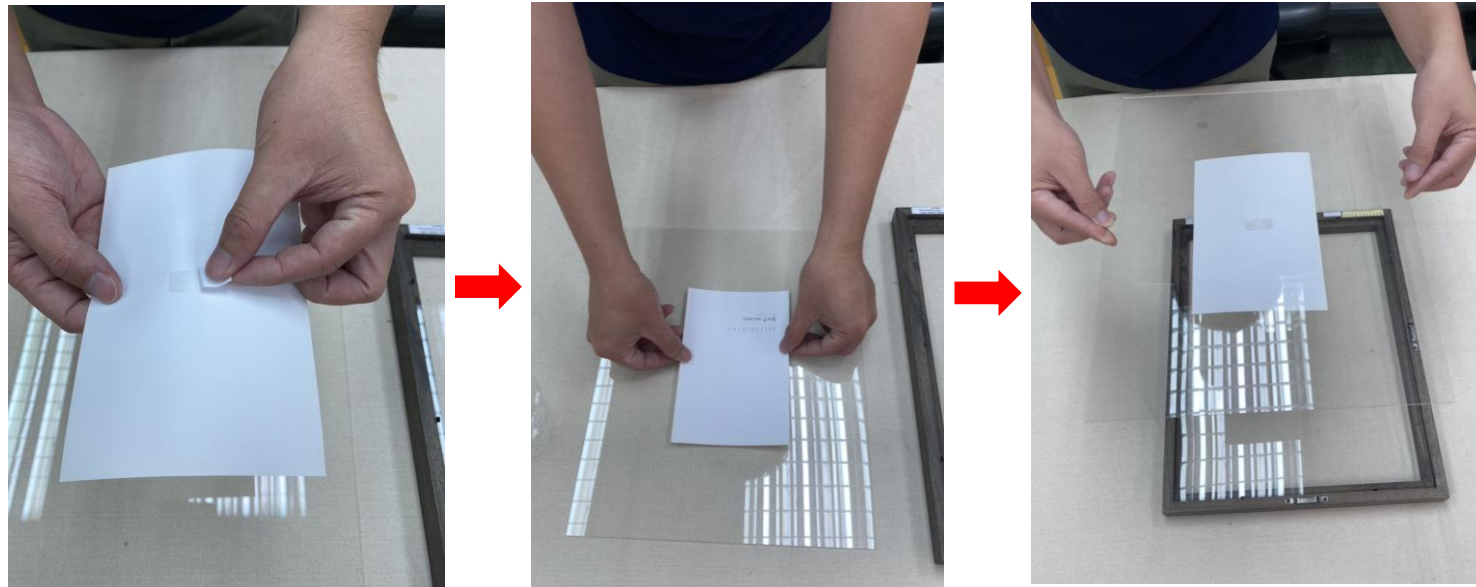

How to insert the image in Floating Frame

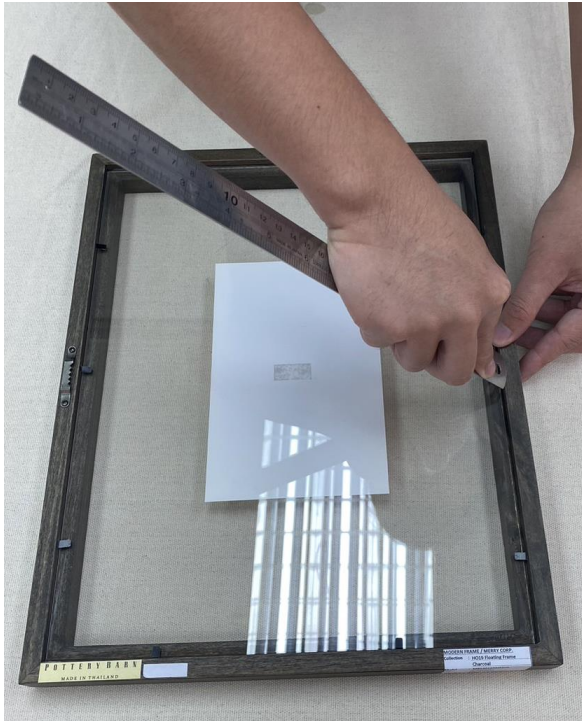
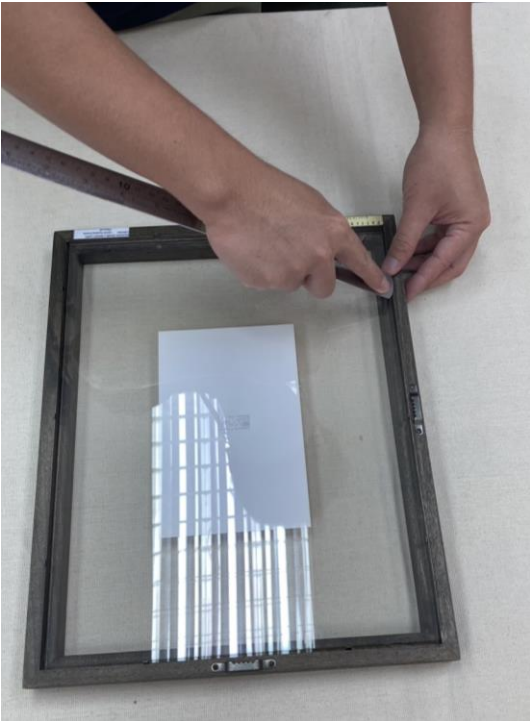

Front Sides



Back Sides

5. Use the ruler to close all flexi tabs.