

P O T T E R Y B A R N

Weston Frame 8X10 Mounting Instructions

Tools Required: Level, Pencil, Phillips Screwdriver, Stud-Finder

Parts included: (1) Picture Frame (1) Hook

Hardware: (2) Anchors (2) Screws

The hardware included with this item is meant for drywall or stud mounting only. If your walls are made from concrete, brick or plaster, please consult your local hardware store for assistance in selecting the appropriate hardware.

The provided hook includes a mounting plate with two screw holes for mounting itself to a wall and therefore it is used to hold the picture frame. An iron hoop is on the top of the picture frame to hang it on the hook.

Mounting Instructions:

- 1) Attach the picture frame to the hook and then position the hook upright at a desired mounting location on a wall. Use a level to ensure that the hook is positioned vertically and use a pencil immediately mark the wall through the two screw holes of the hook. Remove the hook and the picture frame from the wall. The remaining marks on the wall are the insertion points for the mounting hardware.
- 2) The provided anchors cannot penetrate wood studs. Therefore we have to find out if either mark of Step (1) happens to align with a wall stud (use a stud finder to determine this). If either does, do not use the anchor at that mark. **When instructed to do so below, use a screwdriver to secure one of the provided screws through the screw holes of the hook and directly into the wall and aligned wall stud – refer to step (4).**
- 3) For marks that do not align with a wall stud, install an anchor first. To install the anchor, use a Phillips screwdriver to engage an anchor, position the anchor tip against the wall at one of the marks and firmly push it into the wall. The anchor will drive itself into the wall when you rotate it clockwise, while applying an even pressure. Continue rotating until the anchor's head becomes even with the wall surface. Do not over-tighten.
- 4) Reposition the hook (*do not make it upside-down*) to the wall and aligning the screw holes of the hook with either installed anchors or stud marks. Use the screwdriver to secure a provided screw through each screw hole and into the anchors or wall studs. Rotate the screws clockwise until tight.
- 5) Lift up the picture frame and hanging the iron hoop of the frame onto the installed hook on the wall (*as the illustration shown*). Release the picture frame so it rests on the hook.

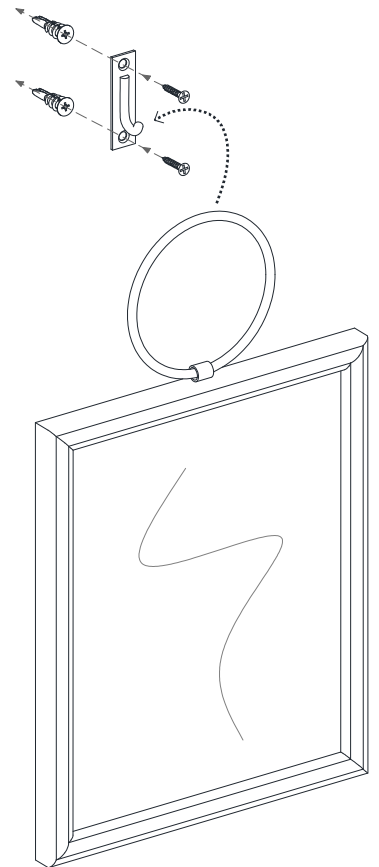

Care Instructions:

- Wipe with a soft, dry cloth.
- Do not use abrasive or strong chemical household cleaners.

Thank you for your purchase!
Stores | Catalog | www.potterybarn.com