

P O T T E R Y B A R N

Lit Dancing Broom (35 lights)

Installation and Use Instructions

These instructions are for your safety. Please read through them thoroughly before use and retain for future reference.

- 1) This Lit Dancing Broom suitable for **INDOOR USE ONLY**.
- 2) Do not position or place near heaters or any other direct sources of heat.
- 3) This product is suitable for positioning on surfaces which have normal flammability e.g. wood, plasterboard, and masonry. However this does not include highly flammable surfaces (e.g. polystyrene, textiles).
- 4) Always position cables and extension leads so that they will not be a hazard to the elderly, pets and children.
- 5) **DO NOT** position this set where it may become covered by other items e.g. curtains, nets or bedding.

How to insert batteries into the product

- a) Unlock the battery box.
- b) Insert new batteries ("AA" type 4 X 1.5V) following the polarity marked on the product.
- c) Lock the battery box.

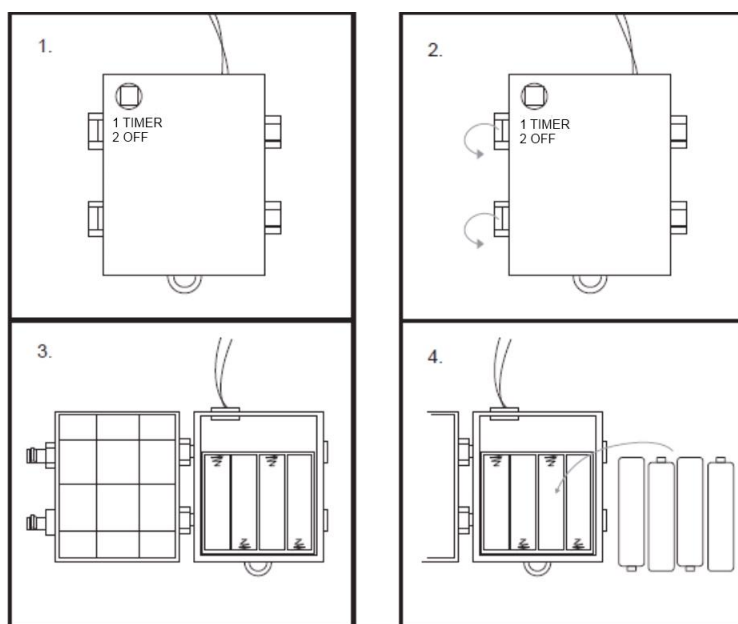

P O T T E R Y B A R N

Battery Box Operation Instructions

- 1) The button "TIMER/OFF" controls the lights on or off.

Timer function

- 1) Set the timer on, the bulbs will light up and stay 6 hours of constant light and then automatically shut down. After 18 hours, it will light up again.

Use and care instructions

1. Before using or reusing, inspect product carefully.
2. Discard any products that have cut, damaged, or frayed wire insulation or cords, cracks in the lampholder or enclosures, loose connects or exposed copper wire.
3. When storing the product, carefully remove the product from wherever it is placed, including trees, branches, or bushes, to avoid any undue strain or stress on the product conductors, connections, and wires.
4. When not in use, store neatly in a cool, dry location protected from sunlight.
5. Clean the product with a soft, dry cloth. Do not use solvents or abrasive cleaners.

CAUTION:

To avoid explosion or leakage, do not dispose of batteries in a fire. Please dispose of batteries safety according to the battery manufacturer's instructions or recycle battery per state and local codes. If battery leakage occurs and comes in contact with the skin or eyes, wash immediately with plenty of water. Batteries should be handled under adult supervision. If the device is not to be used for an extended period of time, remove the battery to prevent damage or injury from possible battery leakage.

THIS IS NOT A TOY: KEEP OUT OF REACH OF CHILDREN AND PETS. NEVER TOUCH ITEMS WITH WET HANDS.

FCC & IC Related Information

"This device complies with Part 15 of the FCC Rules. Operation is subject to the following two conditions:

- (1) This device may not cause harmful interference, and
- (2) This device must accept any interference received, including interference that may cause undesired operation."

Caution: changes or modifications not expressly approved by the party responsible for compliance could void the user's authority to operate the equipment.

"NOTE: This equipment has been tested and found to comply with the limits for a Class B digital device, pursuant to Part 15 of the FCC Rules. These limits are designed to provide reasonable protection against harmful interference in a residential installation. This equipment generates, uses and can radiate radio frequency energy and, if not installed and used in accordance with the

P O T T E R Y B A R N

instructions, may cause harmful interference to radio communications. However, there is no guarantee that interference will not occur in a particular installation. If this equipment does cause harmful interference to radio or television reception, which can be determined by turning the equipment off and on, the user is encouraged to try to correct the interference by one or more of the following measures:

- Reorient or relocate the receiving antenna.
- Increase the separation between the equipment and receiver.
- Connect the equipment into an outlet on a circuit different from that to which the receiver is connected.
- Consult the dealer or an experienced radio/TV technician for help.”

CAN ICES-3 (B).

Use Instructions

- 1) Remove the product from the packing taking care not to damage or twist the wires. This lit dancing broom comes fully assembled.
- 2) Ensure that the cables are fully unwound before use.
- 3) Check the set before use for loose or damaged wiring and that all the bulbs are secure. If you are in doubt do not use the set.
- 4) Replace batteries as a simultaneous set.
- 5) Once checked locate your lights in the desired position.
- 6) This product does not contain lamp shunts, which allow the product to operate if one lamp burns out.

Fault Finding

If the set fails to light, please check the following.

- Open the battery box and check the battery life expectancy, replace battery if necessary
- Check the batteries whether they are correctly positioned in the battery box.
- Check if the terminals are clean.

Warning

- The external cable of this string light can not be replaced, if it is damaged, the string light should be destroyed.
- This product uses long-lasting, non-replaceable LED bulbs.
- Do not connect this string light electrically to another.

P O T T E R Y B A R N

IMPORTANT SAFETY INSTRUCTIONS:

When using products, basic precautions should always be practiced including the following:

1. READ AND FOLLOW ALL SAFETY INSTRUCTIONS.
2. Do not use seasonal products outdoors unless marked suitable for indoor and outdoor use.
3. This seasonal use product is not intended for permanent installation or use.
4. Do not mount or place near gas or electric heaters, fireplaces, candles or other similar sources of heat.
5. Do not secure the wiring of the product with staples or nails, or place on sharp hook or nails.
6. Turn off the product when not use.
7. This is an electric product – not a toy! To avoid risk of fire, burns and personal injury, it should not be placed where small children can reach it.
8. Do not use this product for other than its intended use.
9. Do not hang ornaments or other objects from cord, wire, or light string.
10. Do not close doors or windows on the product or extension cords as this may damage the wire insulation.
11. Do not cover the product with cloth, paper or any material not part of the product when in use.
12. Do not twist lamps.
13. Do not install or use within 10 feet of a pool.
14. Do not use in a bathroom.
15. Never mix old and new batteries in a device. Battery leakage may occur.
16. Replace all batteries in a device at the same time.

SAVE THESE INSTRUCTIONS: This manual contains important safety and operating instructions for power units.

Model No.: Alkaline "AA" type 4 X 1.5V batteries

SKU# 8324642

(Batteries are not included in this product)