

POTTERY BARN

PET ORGANIZER ONE SIZE

Mounting Instructions

Max. Maximum total weight capacity for this product is 100 pounds (45.4 Kg), (5 pounds (2.3 Kg) maximum per hook).

Hardware Included: (3) snap screws (3) screws

Tools Needed: Phillips Screwdriver, Pencil, Stud-Finder, Level, Tape measure

Note:

- **Assembly by two people recommended. Open the box safely and unpack all the included items. Do not discard packing until assembly is completed.**

Step 1: Hold the wooden cleat at desired location understanding that the cleat will represent the top of the item. Note that the sharp edge of the cleat must face up and be away from the wall. Use a level to make sure that the cleat is level and then use a pencil to mark the wall through each of the three holes of the cleat. Set the cleat aside. The mounting hardware is mounted at these three holes.

Step 2: Use a stud-finder to determine if any of the marks of Step (1) aligns with a wall stud. If so, use the screwdriver to secure a provided screw at that mark when instructed to do so below. For marks that do not align with a wall stud, use a screwdriver to install a provided snap screws. Engage the head of the snap screws with the screwdriver and position the snap screws tip at the mark. Rotate the snap screws clockwise while pushing it firmly into the wall until the wide end of the snap screws is even with the wall.

Step 3: Reposition the cleat against the wall so that the three holes of the cleat align with either an installed snap screws, or a stud-aligned mark. Use a screwdriver to secure a screw through each of the three holes and into installed snap screws or stud marks. Rotate each screw clockwise until tight.

Step 4: With the help of another person, hang the item on the wall cleat so that it engages the product.

The hardware included with this item is meant for drywall mounting only. If your wall is made from another material such as concrete or plaster, please consult your local hardware store for assistance in selecting the correct hardware.

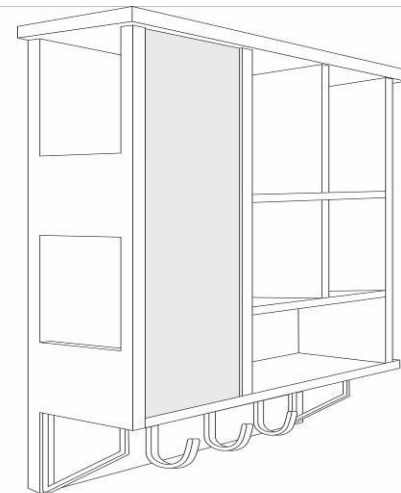
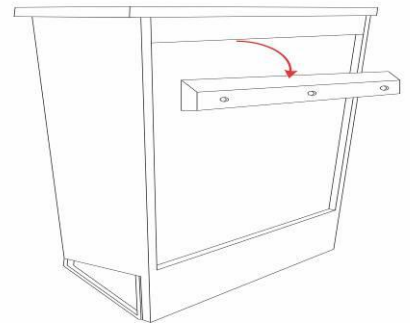
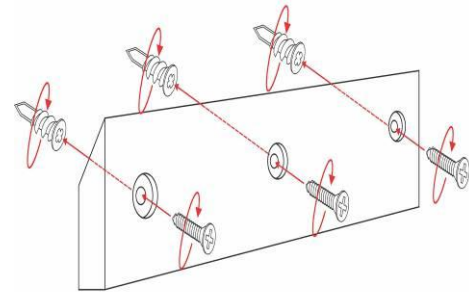

Thank you for your purchase!
Stores | Catalog | www.potterybarn.com