

POTTERY BARN

Pocket Watch Wall Clock Assembly instructions

Note: For safe mounting, it is essential to use the proper hardware for your wall type. Be sure to consult your local hardware store to determine the hardware needed for your wall type (plaster, drywall, concrete, etc.) Mount to wood studs whenever possible.

Parts Included:

- (2) Mounting plates
- (4) Screws
- (4) ITW Mini Anchors
- (2) Hex screws
- (1) Allen Wrench

Needed for Operation:

- (1) 1.5 volt AA battery

Mounting Instructions:

1. Pre-assemble clock within the mounting brackets and plates to determine desired location. Mark location of the screw holes with a pencil. Remove from wall. Use a carpenter's level or measure up from the floor at each mark to be sure the brackets will be vertical.
2. Attach mounting plates onto wall with screws and wall anchors provided or the proper hardware for our wall type.
3. Slide mounting brackets onto mounting plates. Secure by tightening hex screws with Allen wrench.

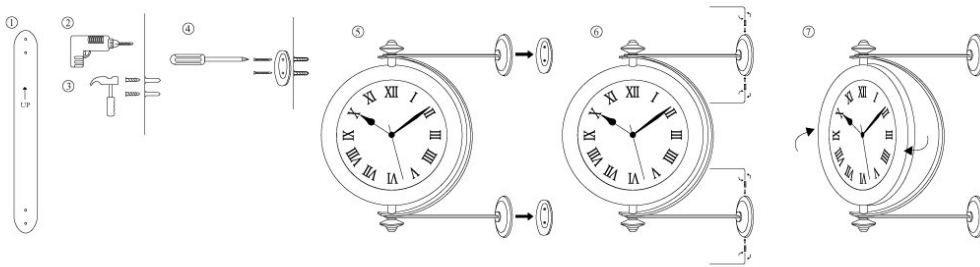

To Install Battery:

1. Open the back of the clock.
2. Insert a new 1.5volt AA battery. Match the battery direction to the polarity markings displayed inside the compartment. Movement should start immediately.
3. Should clock fail to function properly, replace with a new battery and assure that it is correctly positioned in the battery compartment.
4. Remove battery if clock is to be stored.

To Set Time:

The TIME SET dial is located inside the back of the clock. Turn the TIME SET dial in the direction indicated by the arrow until correct time is reached. Do not touch or move hands of clock manually.

Care Instructions:

Wipe clock with a soft, dry cloth. Do not use solvents or abrasive cleaners on clock as they may damage the lacquered finish.

To avoid explosion or leakage, do not dispose of batteries in a fire or attempt to recharge standard or alkaline batteries.